

High efficiency : electric 33.7%, overall 84.0%
 Dry low emissions : NO_x 25ppmv, CO 50ppmv (O₂ = 15%)
 High reliability & easy maintenance

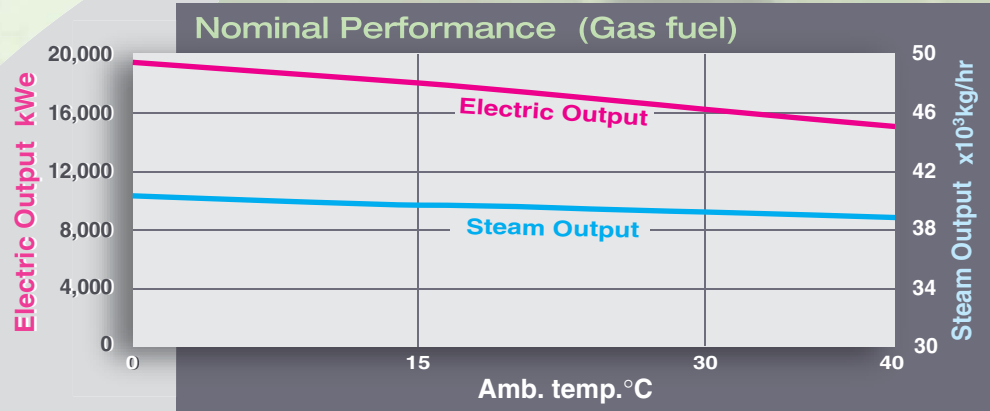

Amb. temp. °C (°F)	Electric Output kWe	Heat Rate kJ/kW-hr	Steam Output x10 ³ kg/hr	Electrical Efficiency %	Total Thermal Efficiency %
0 (32)	19,320	10,508	40.2	34.3	82.5
15 (59)	17,970	10,694	39.7	33.7	84.0
40 (104)	15,080	11,382	38.8	31.6	86.7

Nominal Performance

Elevation : 0 m
 Inlet Air Temperature : 15 °C
 Inlet Air Pressure Loss : 0.98 kPa
 Exhaust Gas Pressure Loss : 2.45 kPa
 LHV of Natural Gas Fuel : 35.9 MJ/Nm³
 (100% CH₄)

Typical Steam Condition

Steam Pressure : 0.83 MPaG
 Steam Temperature (Saturated) : 177 °C
 Feed Water Temperature : 80 °C
 Blowdown from HRSG : 0 %

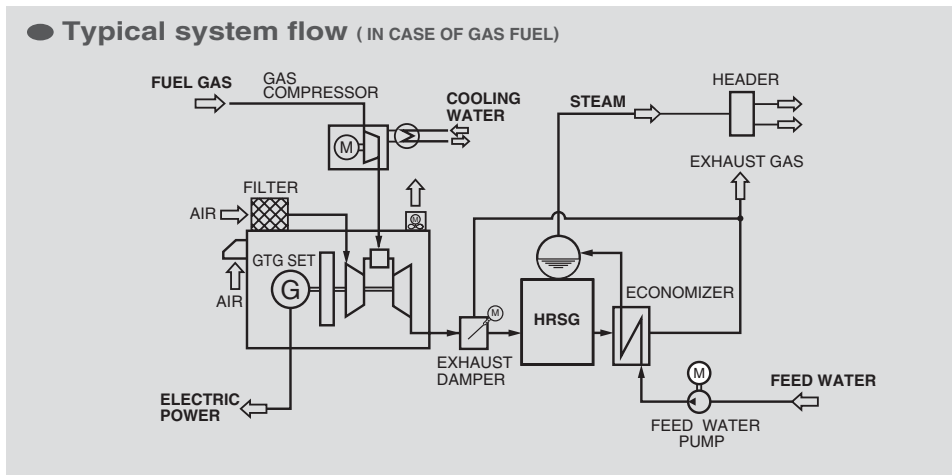

● Typical layout (Unit:mm)

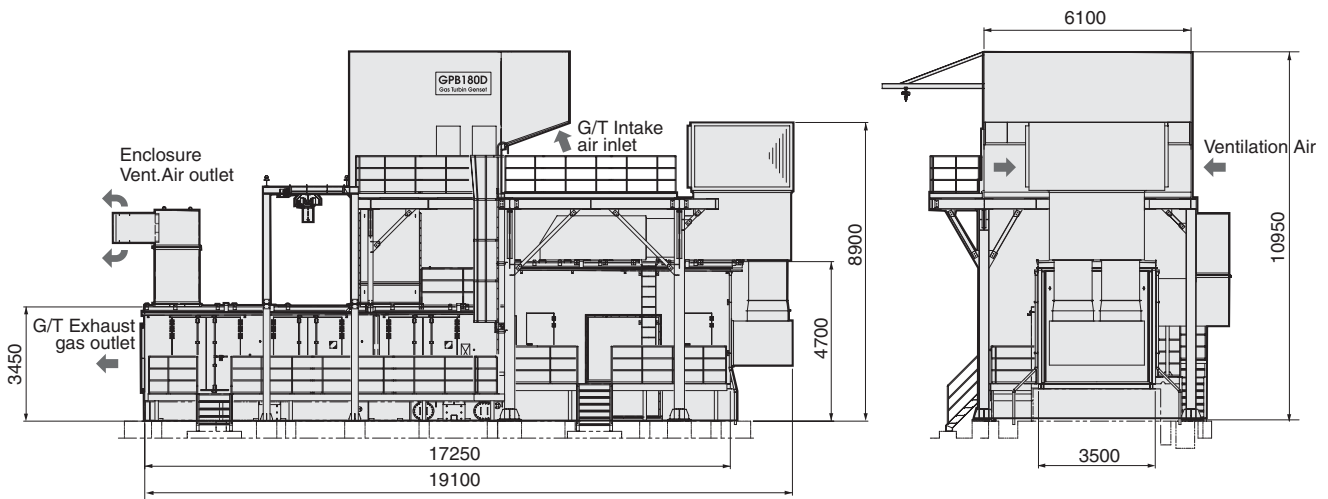

www.khi.co.jp/gasturbine/index_e.html

Kawasaki Heavy Industries, Ltd. Gas Turbine Division
 Phone: +81-3-3435-2232 Fax: +81-3-3435-2592

Kawasaki Machine Systems, Ltd. (Asia Division)
 Phone: +81-3-3435-2977 Fax: +81-3-3435-2592

Kawasaki Gas Turbine Asia Sdn Bhd : (KGA)
 Phone: +60-3-5569-2882 Fax: +60-3-5569-3093
www.kga.com.my

Kawasaki Gas Turbine Europe GmbH : (KGE)
 Phone: +49-6172-7363-0 Fax: +49-6172-7363-55
www.kawasaki-gasturbine.de

Kawasaki Gas Turbines-Americas : (KGT-A)
 Phone: +1-281-970-3255 Fax: +1-281-970-6465
www.kawasakigasturbines.com

Kawasaki Machine Systems, Ltd. (Shanghai Rep. Office)
 Phone: +86-21-3366-3500 Fax: +86-21-3366-3505

Kawasaki Heavy Industries Middle East FZE : (KHI-ME)
 Phone: +971-4-214-6727 Fax: +971-4-214-6729

Kawasaki Gas Turbines-Americas
 (Houston, TX)

Kawasaki Gas Turbine Europe GmbH
 (Frankfurt, Germany)

Kawasaki Heavy Industries, Ltd.
 (Tokyo, Japan)

Kawasaki Machine Systems, Ltd.
 (Shanghai Rep. Office)

Kawasaki Heavy Industries
 Middle East FZE
 (Dubai, UAE)

Kawasaki Gas Turbine Asia Sdn Bhd
 (Shah Alam, Malaysia)

